

REVISIONS		
DATE	NAME	NO.
5-21-13	JAMES R. DATZ	NJL#24GS03671900

"THIS SHEET IS A DIGITIZED COPY OF THE TAX MAP PREPARED BY ROBERT SPINNLER, BOROUGH ENGINEER AND DATED DECEMBER 1963. THE ORIGINAL APPROVED MAP IS ON FILE IN THE ENGINEER'S OFFICE."

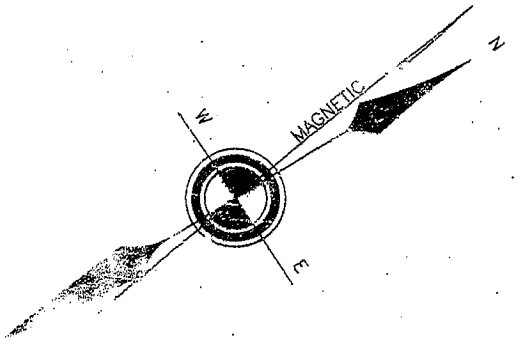

THE AREAS BOUNDARIES AND DIMENSIONS SHOWN ON THIS TAX MAP ARE DERIVED FROM GROUND SURVEYS, AERIAL SURVEYS, AND RECORDED PLANS, MAPS, DEEDS, AND WILLS AND ARE TO BE USED FOR ASSESSMENT PURPOSES ONLY.

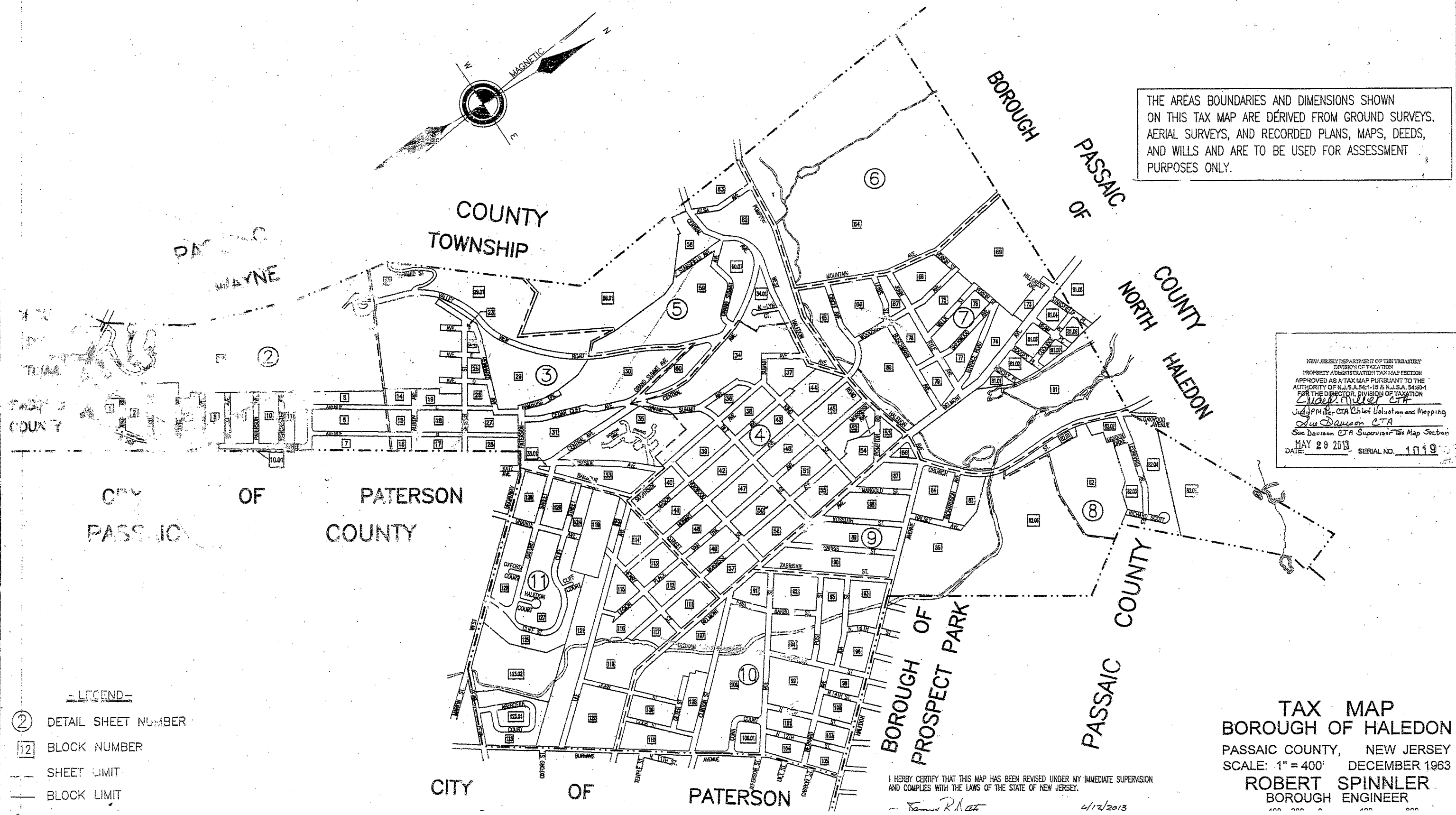

NEW JERSEY DEPARTMENT OF THE TREASURY  
 DIVISION OF TAXATION  
 PROPERTY ADMINISTRATION TAX MAP SECTION  
 APPROVED AS A TAX MAP PURSUANT TO THE  
 AUTHORITY OF N.J.S.A. 54:1-15 & N.J.S.A. 54:30-1  
 FOR THE DIRECTOR, DIVISION OF TAXATION  
*Charles Miller CTA*  
 John P. Miller, CTA Chief Valuation and Mapping  
*Sue Dawson CTA*  
 Sue Dawson, CTA Supervisor Tax Map Section  
 DATE: MAY 29 2013 SERIAL NO. 1019

- LEGEND —
- ② DETAIL SHEET NUMBER
  - BLOCK NUMBER
  - SHEET LIMIT
  - BLOCK LIMIT

I HERBY CERTIFY THAT THIS MAP HAS BEEN REVISED UNDER MY IMMEDIATE SUPERVISION AND COMPLIES WITH THE LAWS OF THE STATE OF NEW JERSEY.  
*James R. Datz* 4/12/2013

TAX MAP  
 BOROUGH OF HALEDON  
 PASSAIC COUNTY, NEW JERSEY  
 SCALE: 1" = 400' DECEMBER 1963  
 ROBERT SPINNLER  
 BOROUGH ENGINEER